

Sunfarm Series

VFD-Solar Pump Controller



About

Servotech is dedicated to creating value through transformative change, with a commitment to advancing a green future through sustainable development and relentless innovation. Our eco-friendly products are designed to lead the way in renewable energy and electric mobility. With an extensive presence spanning over two decades we have curated high value solutions.

Our green product portfolio features comprehensive solar solutions, including solar panels, inverters, and batteries. The Sunfarm series is a notable addition to our robust lineup of efficient solar products, reflecting our forward-thinking approach. Recognizing the importance of integrating cutting-edge technology, we have developed these advanced sunfarm series. Servotech continues to push the boundaries of solar technology, ensuring we deliver superior performance and innovation to our customers.

Solar, Simplified with Sunfarm series

Servotech's Sunfarm series with its new and improved advanced technology redefines the concept of renewable power. Crafted with sincerity, built on reliability, Sunfarm series is a reflection of Servotech's long lasting legacy of technology driven reliable and durable products.

Here is why you should choose us :

- **As a pioneering solar solutions** provider, Servotech leads **innovation** in the **renewable energy sector**, with products trusted by customers globally.
- **The Solar Pump Controller** is an **environmentally friendly, energy-efficient** solar pump that employs solar electricity for agricultural, irrigation, and water supply applications.
- **Using sunlight**, this pump provides a **sustainable** and **cost-effective** alternative to diesel or electric pumps, lowering energy expenditures and **environmental impact**.
- **It is ideal** for rural and off-grid locations, providing consistent water availability while encouraging **renewable energy uptake** and **long-term sustainability**.

Model Reference

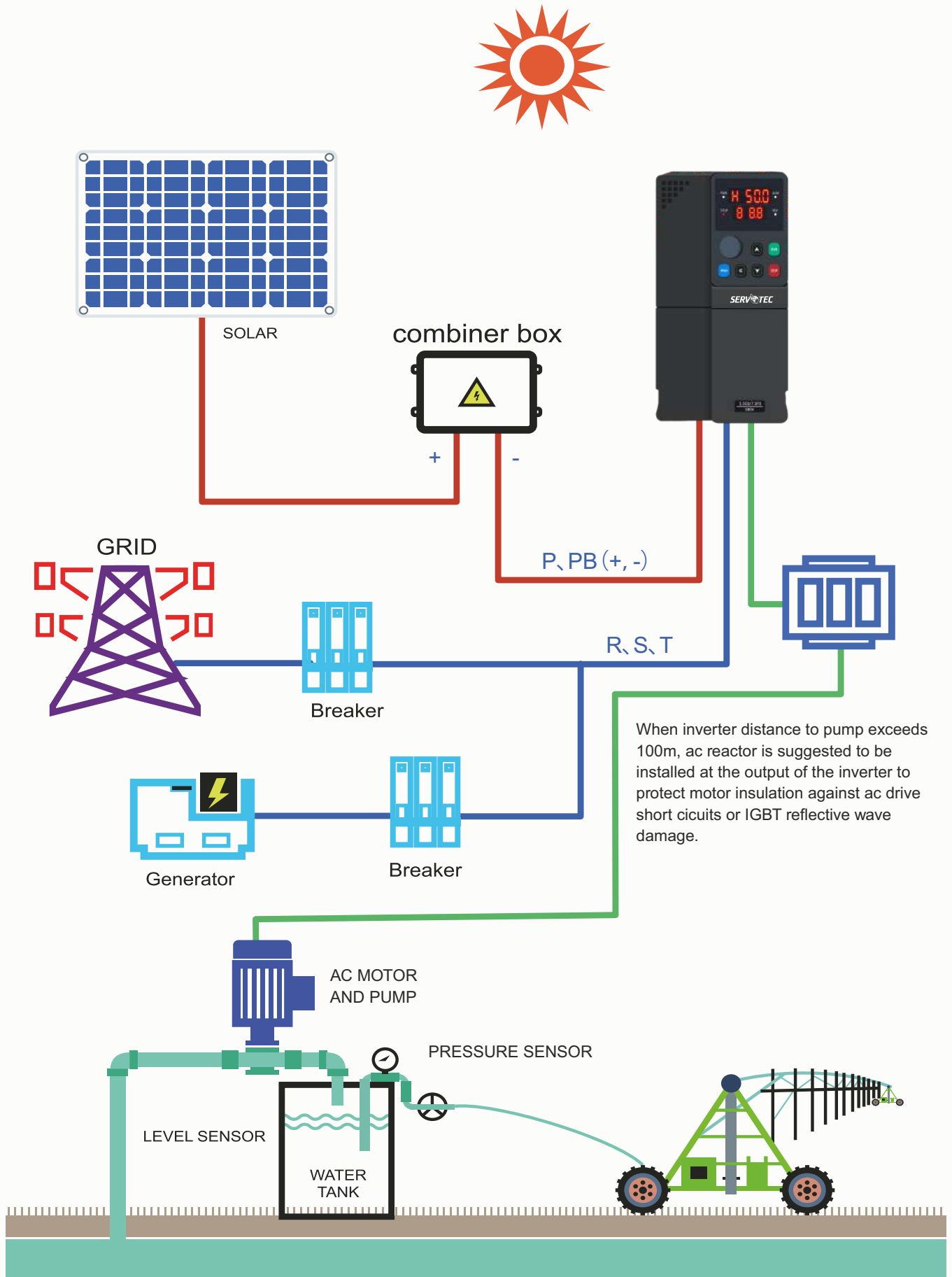

Technical Specifications

Output Voltage	220V	380V
Max input DC voltage(VOC)	400V	800V
DC voltage range	150V -400V	250V -800V
Recommended DC input voltage range(Vmpp)	250V -350V	450V -650V
Recommended input operation voltage	320V (Vmpp)	500 (Vmpp)
MPPT efficiency	>99%	
Rated output voltage	1/3-phase 220VAC	3-phase 380V-480V VAC
Output frequency range	50/60Hz(maximum500Hz)	
Max efficiency of the machine	99%	
Ambient temperature range	-10 °C-40°C, derating if the temperature is above 40 °C	
Cooling method	Air cooling	
Protection degree	IP20/P21	
Altitude	Below 1000m; above 1% for every additional 100m.	

Model Range

NO	Power	Dimension(mm)			Installation Size(mm)		Hole Φ
		W	D	H	W1	H1	
ST-A00	0.75-2.2KW/220V 0.75-2.2KW/380V	170	86	141	157	75	5MM
ST-A01	4-5.5KW/380V	188	96	171	176	83.6	5MM
ST-A02	7.5-11KW	228	114	192	214.5	98.7	5MM
ST-A03	15-18.5KW	290	160	182	269	143	6.5MM
ST-A04	22-30KW	328	193	217	305	172	8.5MM
ST-A05	37-45KW	344	228	223	324	206	8.5MM
ST-A06	55KW	490	327.5	238	459	202.5	10MM
ST-A07	75-93KW	526	300	304	504	200	9MM
ST-A08	110-132KW	690	370	360	636.5	232	10MM
ST-A09	160-220KW	720	410	360	690	330	10MM
ST-A10	250-315KW	1060	650	392.5	1030	420	12MM
ST-A11	355-500KW	1361.5	818	404.5	1280	520	16MM

*Due to product upgrade, size update without prior notice, Consult staff for details.

Product Size

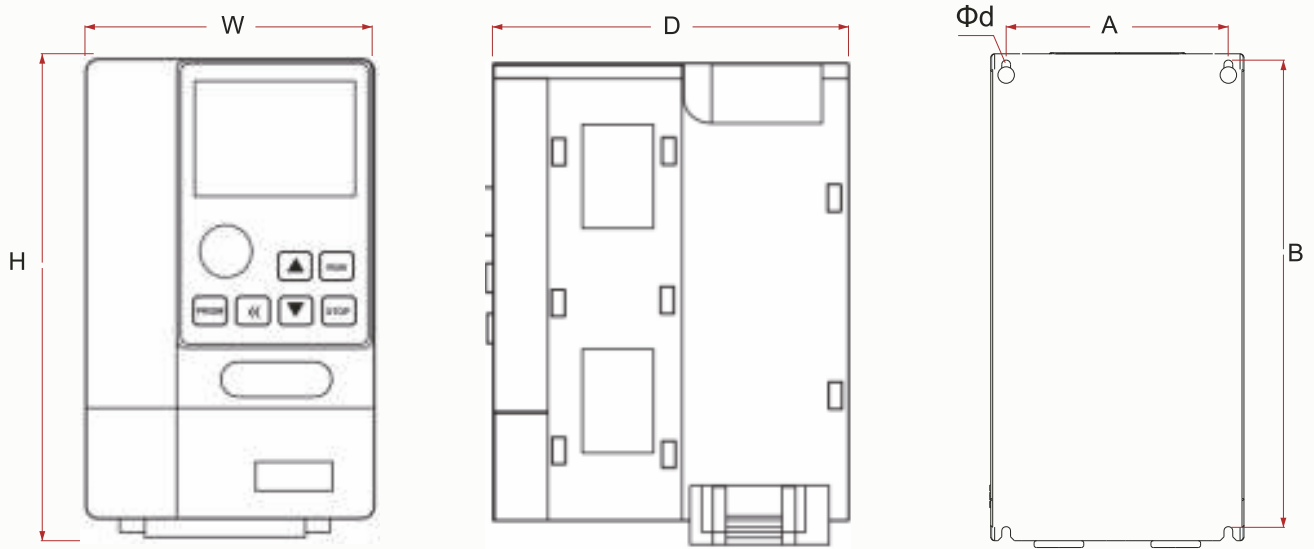

LED & LCD Keypad

1. Standard LED keypad, LCD keypad optional. Both can monitor 2 parameters at the same time
2. Copy keypad optional. It can copy parameters from one inverter to another. Inverters must be of the same model



INDIA'S
TRUSTED



**रहो रेशन
बिना टेंशन...**

Servotech Renewable Power System Ltd.

Corporate Office : 806, 8th Floor, Crown Heights, Sector-10, Rohini, New Delhi - 110085

Ph: 011-41183116, +91 9818680033

 **+91 9311313734**

Email: servotech@servotechindia.com

Website: www.servotech.in

Reg. Add. & Kundli Plant: Khata No. 1970, Khewat No. 1672, Khasra No. 21/20/2/2, Revenue Estate, Kundli, P.S.Rai, Sonipat, Haryana - 131029

Safabad Plant: Killa No. 14/6/1/2 (0-3), 6/2/3 (5-13) Village-Safabad, Pana Paposhian, Rai, Sonipat, Haryana - 131029

Warehouse: Khasra No. 8/5, 6, 14/2, 15/1, 16/2 Min & 17, Jakhali Road, Jhundpur, Sonipat, Haryana - 131021

